



**MAX-FRESH**  
HOT/COLD SYSTEMS



Model AFCP-050-7

Model AFCP-067-7

## Fractional Sized NSF 7 Cold Pans

### Model

AFCP-050-7 (1/2 Size)

AFCP-067-7 (2/3 Size)

### STANDARD FEATURES

- ❑ 3" recessed top edge to comply with NFS-7 requirements  
Self contained drop-in design
- ❑ Model AFCP-50-7 holds a standard 12" x 10" 1/2 size or equivalent fractional pans
- ❑ Model AFCP-67-7 holds a standard 2/3rd size or equivalent fractional pans. Includes an adapter bar to accommodate 2 each 1/3 size pans, 4 each 1/6th size pans or 6 each 1/9th size pans
- ❑ Stainless steel top and liner for maximum strength and durability
- ❑ On/off switch with 8' cord & plug for easy installation and operation
- ❑ Type 134A CFC free refrigerant
- ❑ Recessed ledge for pan support and colder, fresher products
- ❑ Quick & easy service with sight glass, service valves, filter/dryer and receiver
- ❑ Limited 1 year parts & labor warranty

### OPTIONS & ACCESSORIES

- ❑ Perforated bottom strainer plate conveniently holds ice above drain to prevent clogging
- ❑ Remote models with or without condensing units
- ❑ Adaptor bars for fractional sized pans
- ❑ Remote on/off switch
- ❑ 220/230/240V
- ❑ 50 cycle

### DESCRIPTION

USECO Refrigerated Drop-In Cold Pans hold pre-chilled food products at cold, fresh and safe serving temperatures. All models are completely self-contained 1/2 size fractional and 2/3 size fractional as well as in one to six-pan models with individual thermostatic controls, are CFC free and include an 8 ft. 120V cord and plug. Pans are recessed 3" to comply with NSF-7 performance requirements.

### SPECIFICATIONS

**Exterior** – One-piece top flange and coved-corner interiors constructed of 18 gauge stainless steel. Exterior body constructed of heavy gauge, corrosion resistant steel. Condensing unit mounted on corrosion resistant frame below the cold pan.

**Interior** – CFC free foamed-in-place insulation through-out, 1" drain located in the center for easy cleaning. Ledge is recessed 3" to comply with NSF-7 requirements, allowing a layer of air to insulate food and for pan support.

**Refrigeration** – Air cooled, type 134A or 404A CFC free refrigerant system featuring wrapped coil construction on both sides and bottom, individual thermostats, on/off switch, 8 ft. cord and plug set NEMA 5-15P (120V models). Refrigeration system features sight glass, easy service valves, dryer/filter and receiver.



## Model AFCP-050-7

shown below

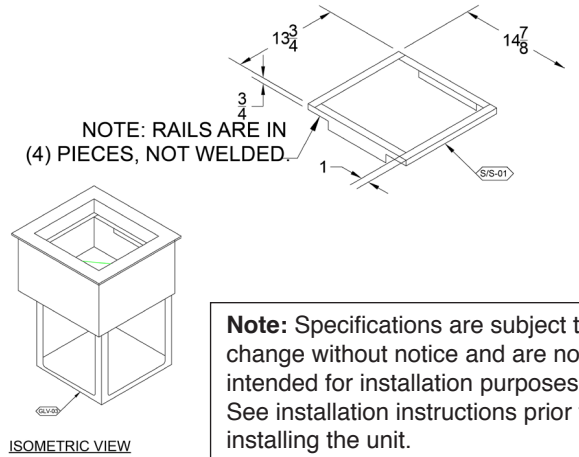
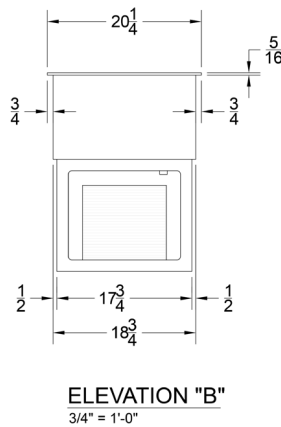
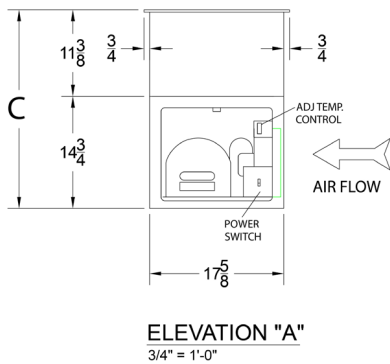
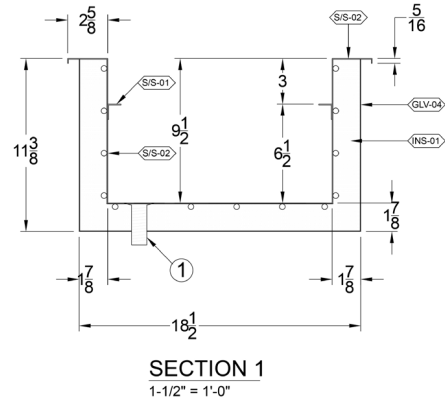
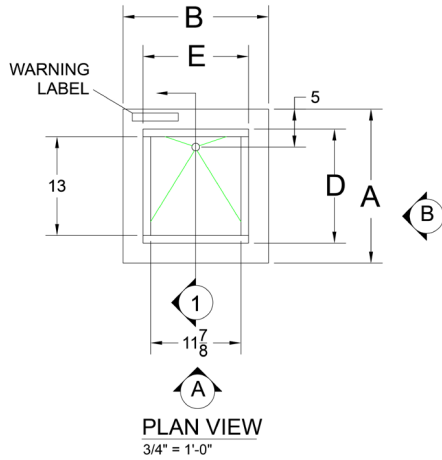

### SPECIFICATIONS

MODELS	DIMENSIONS [inches/[mm]]						
	OVERALL			INTERIOR		CUT OUT	
	A DEPTH	B WIDTH	C HEIGHT	D DEPTH	E WIDTH	F DEPTH	G WIDTH
AFCP-050-7	16 3/4 [425.5]	19 1/8 [486]	26 1/8 [664]	13 7/8 [339.7]	11 1/2 [292.2]	17 7/8 [454]	15 1/2 [393.7]
AFCP-067-7	20 1/4 [514.4]	19 1/8 [486]	26 1/8 [664]	13 7/8 [339.7]	15 [381]	17 7/8 [454]	19 [482.6]

### SHIPPING INFORMATION

DIMENSIONS					
WEIGHTS		CARTON			CRATE FT <sup>3</sup> /[M <sup>3</sup> ]
SHIP	INSTALL	DEPTH	HEIGHT	WIDTH	
75 [34.0]	65 [29.5]	20 [508]	32 [812.8]	23 [584.2]	[8.5] .24
85 [38.5]	75 [34.0]	23 [584.2]	32 [812.8]	23 [584.2]	[9.8] .28

### POWER SUPPLY

MODELS	VOLTS	HP	AMPS	PHASE	POWER	REFRIGERANT
AFCP-050-7	115	1/4	3.7	SINGLE	NEMA 5-15P	134A
AFCP-067-7	115	1/4	3.7	SINGLE	NEMA 5-15P	134A